

## Eco Preparation 1600 mm Sink with 2 Bowls - Right drain

ITEM # \_\_\_\_\_

MODEL # \_\_\_\_\_

NAME # \_\_\_\_\_

SIS # \_\_\_\_\_

AIA # \_\_\_\_\_

**132904 (SL216DN)**Sink Unit with 2 bowls right-  
hand drainer  
500x500x250mm, 1600mm

### Short Form Specification

**Item No.** \_\_\_\_\_

Worktop in 304 AISI stainless steel with front edge h=50mm.  
Rear upstand h=100mm. N.2 bowls 400x500x250h mm.  
Front and side covering panels in stainless steel. Rear panel  
in stainless steel. Square section legs 40x40mm in stainless  
steel with adjustable feet.

### Main Features

- Sturdiness, stability and reliability of table accurately tested.

### Construction

- Constructed entirely in stainless steel to offer maximum durability.
- Delivered in knock-down package.
- Wide range of taps are available to suit every need.
- Drainage area suitable for drying operations

### Optional Accessories

- Lower shelf for 1600mm tables PNC 855147 ☐  
and sinks
- Set of 4 wheels (2 with brake) PNC 855150 ☐  
d. 100mm for tables and sinks  
(total height on wheels= 993  
mm)
- 3-sided underframe for PNC 855154 ☐  
1600mm tables
- Single plastic drain syphon 1,5 PNC 855306 ☐  
" for work tables with bowl
- Elbow operated mixer tap with PNC 855322 ☐  
spout 3/4", single hole
- Elbow operated mixer tap with PNC 855323 ☐  
short spout 3/4", single hole
- Foot operated mixer tap (hot PNC 855328 ☐  
and cold) with spout 3/4"

**APPROVAL:** \_\_\_\_\_

Front

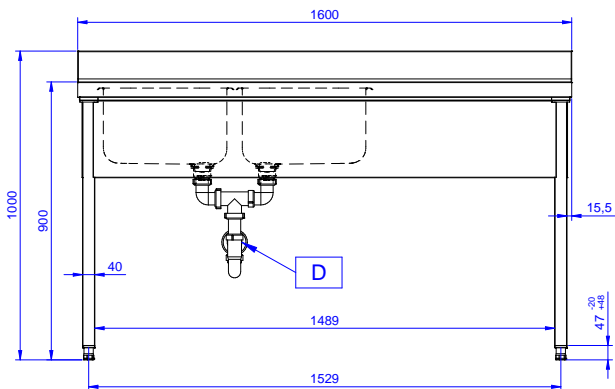

Side

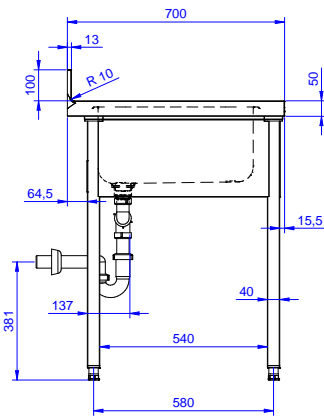

D = Drain

Top

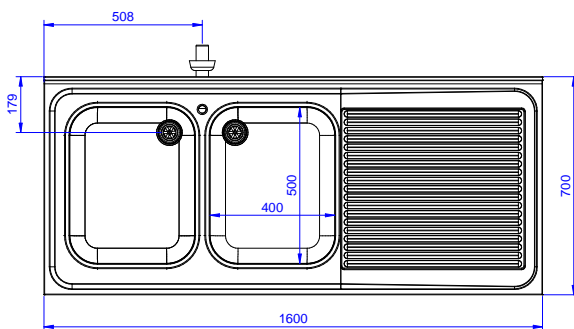

### Key Information:

External dimensions, Width:	1600 mm
132904 (SL216DN)	
External dimensions, Depth:	700 mm
External dimensions, Height:	900 mm
Upstand Dimensions, Height:	100 mm
Upstand Dimensions, Depth:	13 mm
Upstand Dimensions, Radius:	R=10
Bowls number	2
Bowl dimensions	400X500XH250
Net weight:	48 kg